

# GREYSTONE

*Exclusive Brokers  
for Suburban Station*

# Suburban Station Retail Opportunity



## PROPERTY DETAILS

This retail unit boasts 3,385 sq ft of adaptable space, ideal for a variety of uses. This space is centrally located within the below-grade concourse, with and includes large glass frontage in a prime location within the station.

SEPTA's Suburban Station is centrally located in Center City Philadelphia, and serves as a vital link between various transit modes including regional rail, subway, and bus services. The station's centrality captures both commuter and office worker traffic.

**Size:** 3,385 SF

**Daily Ridership:** ±13,000

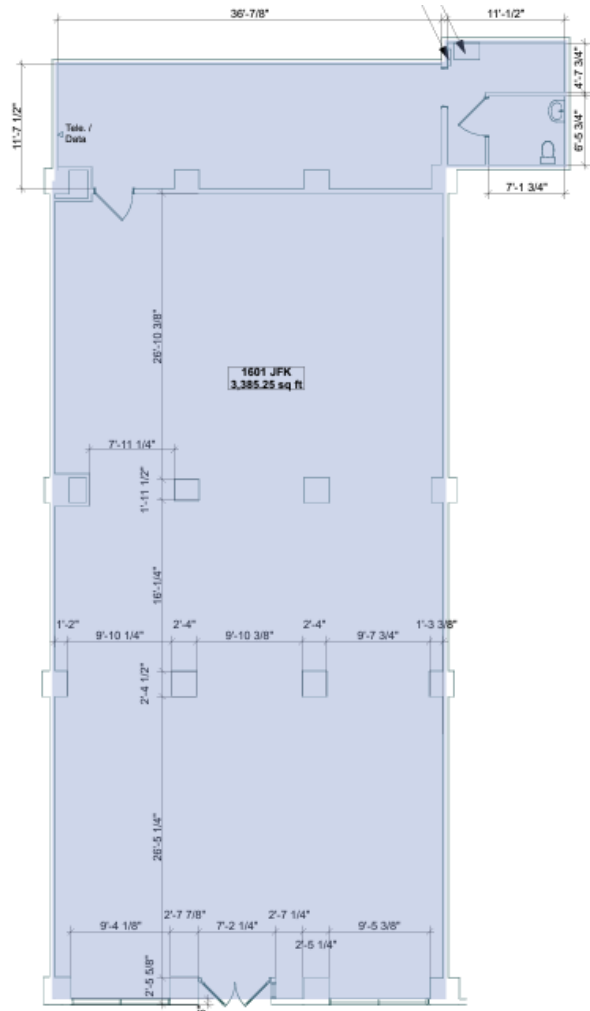

**For more information please contact:**

Greystone Brokerage Services LLC

Charles Di Maggio | (215) 918-8892

SEPTALeasing@greyco.com

**± 3,385 SF | RETAIL SPACE**

**Space #1601**

