

GREYSTONE

Suburban Station

*Exclusive Brokers
for Suburban Station*

Retail Opportunity

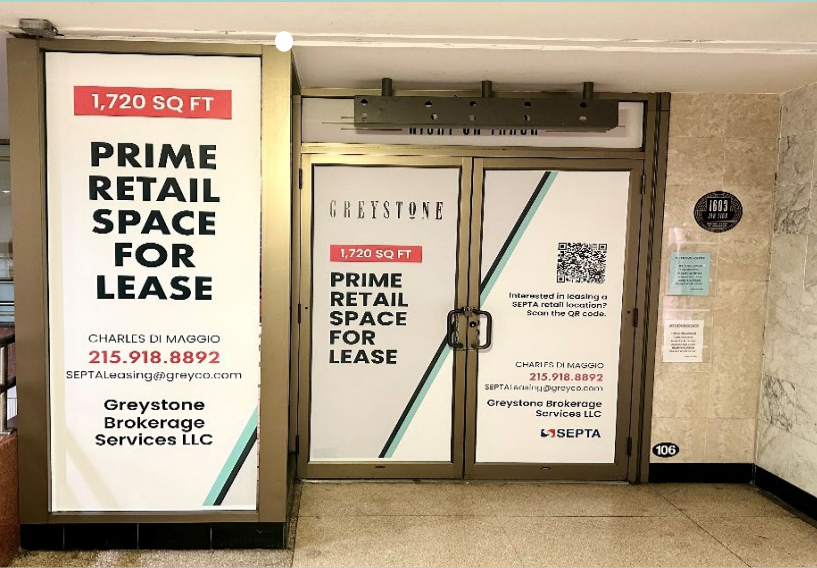

PROPERTY DETAILS

The 1,720 square foot space is centrally located within the main rotunda of SEPTA's Suburban Station, with entrances and frontage in both the paid seating area and publicly accessible non-paid area of the station, conveniently located near SEPTA's ticketing offices. This centrally located space is ideal for a variety of uses, and benefits from high visibility.

SEPTA's Suburban Station is centrally located in Center City Philadelphia, and serves as a vital link between various transit modes, including regional rail, subway, and bus services. The station's centrality captures both commuter and office worker traffic.

Size: 1,720 SF

Daily Ridership: ±13,000

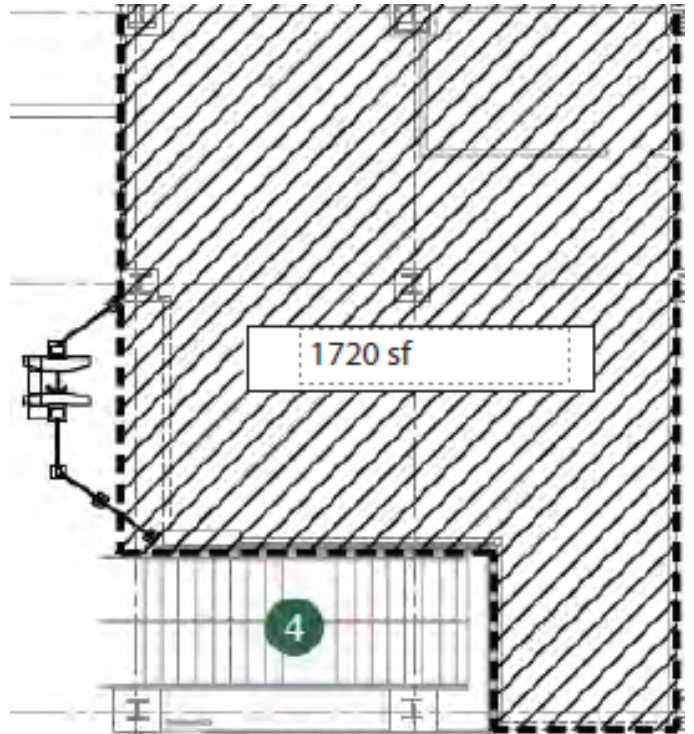

AVAILABLE FOR LEASE

± 1,720 SF | RETAIL SPACE

UNIT # 1603



For more information please contact:

Greystone Brokerage Services LLC

Charles Di Maggio | (215) 918-8892

SEPTAleasing@greyco.com