

GREYSTONE

Suburban Station

*Exclusive Brokers
for Suburban Station*

Retail Opportunity



PROPERTY DETAILS

This 213 square foot space contains 20 feet glass frontage within a high visibility corridor of Suburban Station, and could include an option for pop-out space directly in front of the space. This is located adjacent to a popular Dunkin Donuts, and is very close to a constant flow of potential customers. The space is currently in shell form and ready for buildout, and includes an area of approximately 213 SF.

SEPTA's Suburban Station is centrally located in Center City Philadelphia, and serves as a vital link between various transit modes, including regional rail, subway, and bus services. The station's centrality captures both commuter and office worker traffic.

Size: 213 SF

Daily Ridership: ±13,000

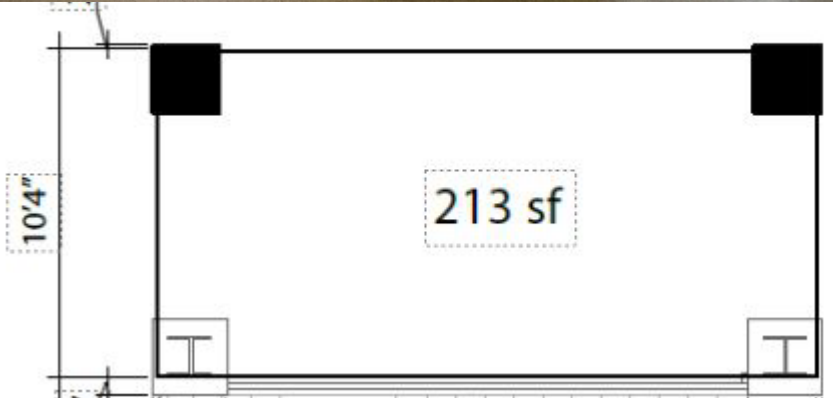

AVAILABLE FOR LEASE

± 213 SF | RETAIL SPACE

UNIT # 1610



For more information please contact:

Greystone Brokerage Services LLC

Charles Di Maggio | (215) 918-8892

SEPTAleasing@greyco.com