

GREYSTONE

*Exclusive Brokers
for Suburban Station*

Suburban Station Retail Opportunity



PROPERTY DETAILS

A Prime Opportunity at Suburban Station!

Located on the bustling main concourse of Suburban Station, this 1,920 square foot space offers unparalleled visibility and foot traffic, making it the perfect location for a food service use. Situated close to adjacent food uses, this space includes essential amenities including two customer restrooms, a large preparation area, dish sink, and a walk-in refrigerator/freezer. There is also space for a significant customer seating area, and large service counter.

SEPTA's Suburban Station is centrally located in Center City Philadelphia, and serves as a vital link between various transit modes including regional rail, subway, and bus services. The station's centrality captures both commuter and office worker traffic.

Size: 1,920 SF

Daily Ridership: ±13,000

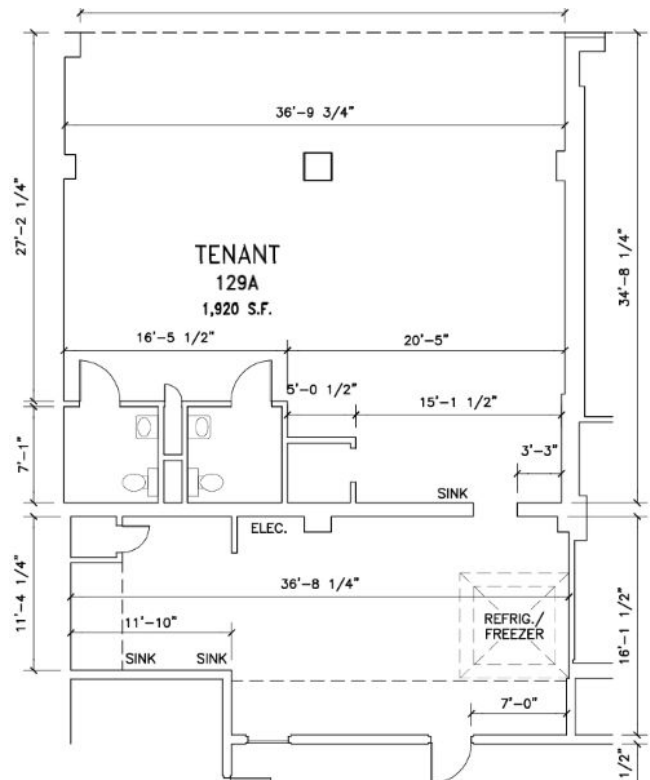

AVAILABLE FOR LEASE

± 1,920 SF | RETAIL SPACE

UNIT # 1616



For more information please contact:

Greystone Brokerage Services LLC

Charles Di Maggio | (215) 918-8892

SEPTAleasing@greyco.com